



Solenoid Valve, water air nitrogen CO2 diesel etc. Normally Close, With pilot control - Brass NBR=Buna, EPDM, FKM=Viton, H-NBR

21W3KB190

21W7KB500

PRESENTATION:

S.V. with pilot control for interception of fluids compatible with the construction materials.

A minimum operational pressure of 0,2 bar is required.

The materials used and the tests carried out ensure maximum reliability and duration.

USE: AUTOMATION-HEATING-HYDRAULICS-IRRIGATION-
FOUNTAINS-CAR WASH-FIRE-COMPRESSED AIR-HOME
AUTOMATION-REFRIGERATION-AGRICULTURE-INDUSTRY-
NAUTICAL-HEAT EXCHANGE

PIPES: G 3/4 - G 2

COILS: 8W - Ø 13
BDA -BDS - BSA 155°C (class F)
BDP 160°C (high temperature)
BDF 180°C (class H)
SDH 180°C (class H)

MOULDING AND BOBBIN ARE MADE BY 100% VIRGIN MATERIAL.

Max. allowable pressure (PS)

G 3/4 - G 1 25 bar

G 1 1/4 - G 2 16 bar

Environment temperature:

with class **F** or high temperature coils - 10°C + 60°C

with class **H** coil - 10°C + 80°C



Gaskets	Temperature		Medium
B=NBR (nitrile rubber)	- 10°C	+ 90°C	Air, inert gas, water
E=EPDM (ethylene-propylene)	- 10°C	+140°C	Water, low pressure steam
V=FKM (fluoroelastomer)	- 10°C	+140°C	mineral oils (2°E), gasoline gas oil
F = H-NBR (hydrogenated nitrile)	- 30°C	+130°C	Water, air, inert gases, R 134a, R404a

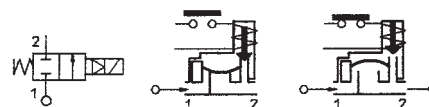

For seals other than NBR replace the letter "B" with the ones corresponding to the other seals. E.I. 21W3KE120.

Pipe ISO 228/1	Code	Max viscosity		Ø mm	Kv (l/mn)	Power (watt)	Pressure		
		cSt	°E				min bar	M.O.P.D.	
G 3/4	21W3KB190	12	~ 2	19	140	8	0,2	16	16
G 1	21W4KB250			25	190				
G 1 1/4	21W5KB350			35	400			10	10
G 1 1/2	21W6KB400			40	520				
G 2	21W7KB500			50	750				

IDROENERGIAITALIA

Master distributor ODE

Sede Legale

Registered Office

00195 Roma (RM) Via Carlo Mirabello, 14



CE Approval

(Pressure Equipment Directive 97/23/CE)

for S.V. 21W5÷21W7

Ufficio Commerciale e sede logistica

Commercial and Logistic Office

73100 Lecce (LE) - Via Parini, 48

Tel: +39 0832090005

fax: +39 0832090006

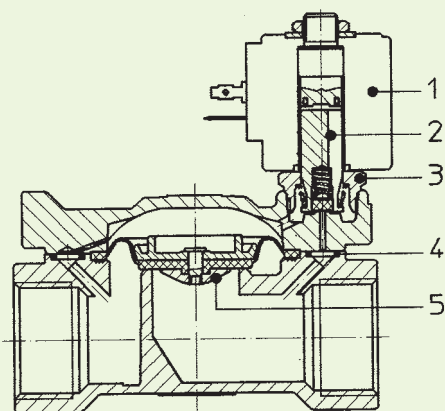

MATERIALS:

Body	Brass - UNI EN 12165 CW617N
Armature tube	Stainless steel AISI series 300
Fixed core	Stainless steel AISI series 400
Plunger	Stainless steel AISI series 400
Phase displacement ring	Copper - Cu 99,9%
Spring	Stainless steel AISI series 300
Seal	Standard: B=NBR On request: E=EPDM V=FKM
Orifice	Brass - UNI EN 12165 CW617N

On request:

Connector	Pg 9 or Pg 11
Connector conformity	ISO 4400

FEATURES:

Electrical conformity	IEC 335
Protection degree	IP 65 EN 60529 (DIN 40050) with coil fitted by connector.

SPARE PARTS:

1. Coil:	See coils list	KIT:	KT130KB30-A=2+3
2. Complete plunger:	Code R450886/B	MAINTENANCE KIT:	
3. Complete armature tube:	Code R450606	G 3/4-G 1	KTG0W3KB19=2+4+5
4. Gasket O-Ring:	G 3/4-G 1 Code R990002/B	G 1 1/4-G 1 1/2	KTG0W5KB35=2+4+5
	G 1 1/4-G 1 1/2 Code R990005/B	G 2	KTG0W7KB50=2+4+5
5. Complete diaphragm:	G 3/4-G 1 Code R450431/B		
	G 1 1/4-G 1 1/2 Code R450466/B		
	G 2 Code R450432/B		

DIMENSIONS:

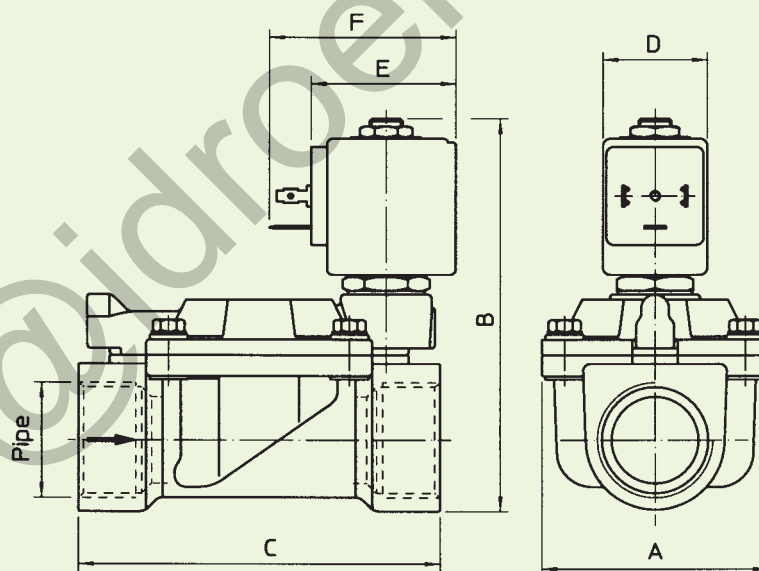

Type	Pipe ISO 228/1	A mm	B mm	C mm
21W3KB190	G 3/4	65	105	104
21W4KB250	G 1		112	
21W5KB350	G 1 1/4	98	125	144
21W6KB400	G 1 1/2			
21W7KB500	G 2	118	141	172

COIL W ---	POWER ABSORPTION		TYPE	DIMENSIONS		
	Inrush VA ~	Hold VA ~		D mm	E mm	F mm
8 W	25	14,5	B	30	42	54
			S	32		